



THE PRESIDENTS SERIES

Van Buren

3 Bedrooms, 2½ Bathrooms
Two-car garage

Main Level: 1,651 sq. ft.
Second Level: 887 sq. ft.
Total: 2,538 sq. ft.

A spacious first floor master suite, lots of cathedral ceilings with gable glass, and a large, open kitchen distinguish this comfortable home. Three bedrooms, an open loft, and a bonus room above the 3-car garage give this remarkable home room to spare.

Presidents Series homes offer:

- Innovative styling from Design Basics.
- Premium materials and components.
- Custom modifications and engineering.
- Complete weather-tight materials package.

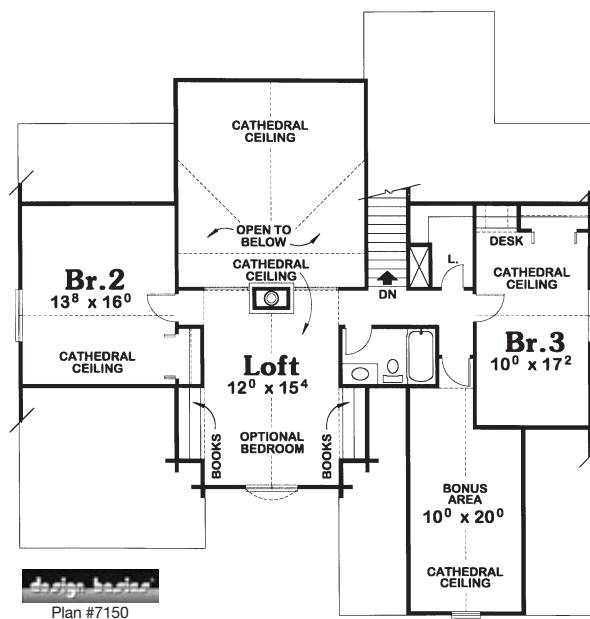
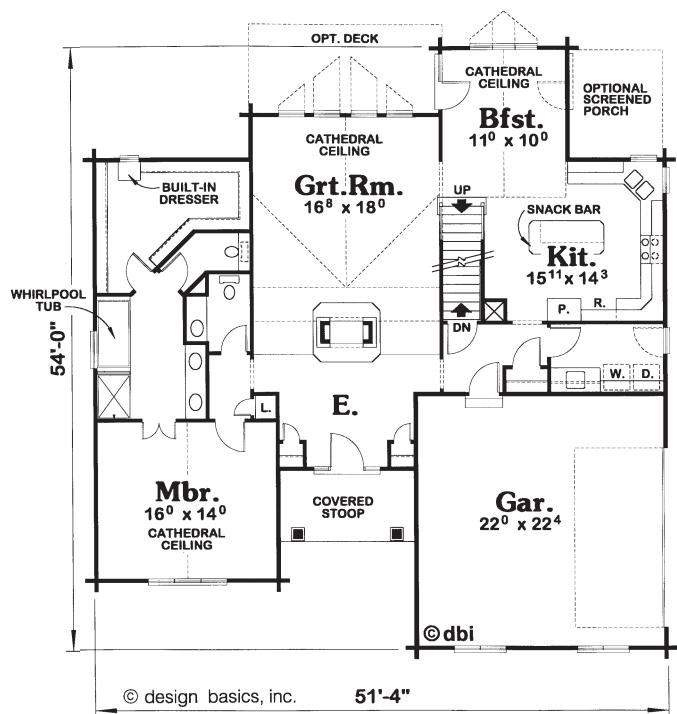

THE ORIGINAL
Lincoln Logs[®]
LTD.

(800) 833-2461, www.lincolnlogs.com

© 2004 Lincoln Logs Ltd. Drawings and renderings are the artist's conceptions and may vary from the actual building plans. © Design Basics Floorplans